

To help avoid damage to the sliding load floor and other vehicle parts:

- ⊠ Do not exceed 1000 lbs (453.5 kg).
- ⊠ Distribute load evenly and secure it to vehicle tiedowns.
- ⊠ Do not drive with the load floor extended or unlocked.

(PRINTED IN USA)

Pour éviter d'endommager le plancher de coffre coulissant ainsi que d'autres pièces du véhicule:

- ⊠ Ne pas excéder 453.5 kg (1000 lb).
- ⊠ Répartir la charge également et la fixer aux points d'arrimage du véhicule.
- ⊠ Ne pas conduire si le plancher du coffre est allongé ou non verrouillé.

Para evitar que se dañe el piso de carga deslizante y otras piezas del vehículo:

- ⊠ No supere los 453.5 kg (1000 lb).
- ⊠ Distribuya la carga uniformemente y fijela a los amarres del vehículo.
- ⊠ No conduzca con el piso de carga extendido o destrabado.

89963964

## PARTS ENCLOSED

### MIDGATE BRACKETS

Driver side

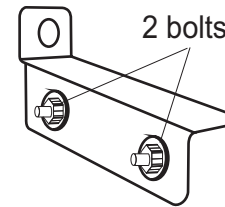

2 bolts per bracket.  
**3/8**

Passenger side

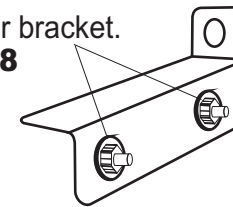

**Two (2) Midgate brackets**  
**Four (4) 3/8 Bolts and nuts.**

### TOOLS NEEDED:

- 2 qty. 1/2" open end wrenches
- Wrench for factory tie-down bolts = Hex Head (Torx on some models)

**1**

**TAILGATE**  
(REAR OF VEHICLE)

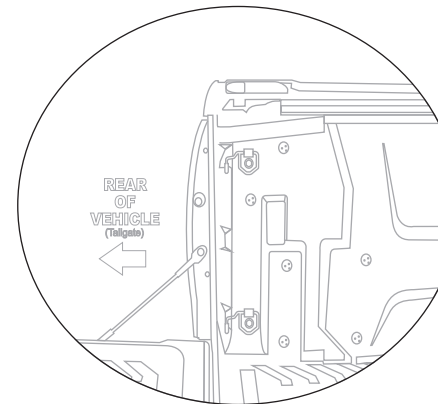

**MIDGATE**  
(FRONT OF VEHICLE)

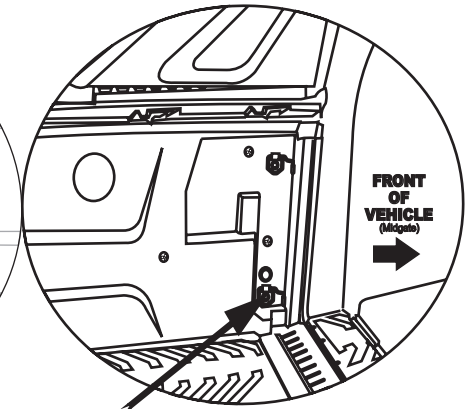

**STEP 1** Remove 2 Factory tie-down bolts: (2 at midgate floor)  
Right and left sides of vehicle.

**2**

**MIDGATE**

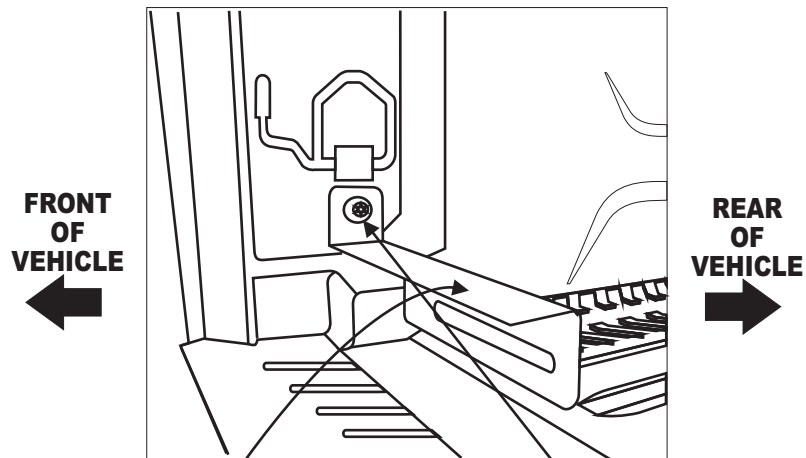

**STEP 2** Place Midgate brackets as shown above and attach with tie down bolts previously removed in step 1.

**Do not tighten yet.**

**3**

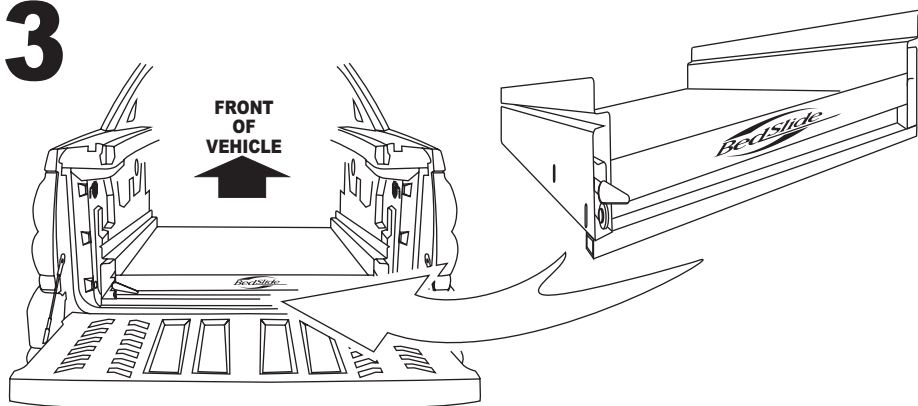

**WITH ADEQUATE HELP !**

**STEP 4** Place the Bedslide unit in vehicle up against Midgate brackets. Using the Bedslide latch located near the tailgate, unlatch the sliding floor and pull back approximately 12" to allow room to attach midgate brackets. DO NOT slide all the way out until the Midgate brackets are secured! If vehicle is not level during installation, temporarily secure the Bedslide from movement .

**4**

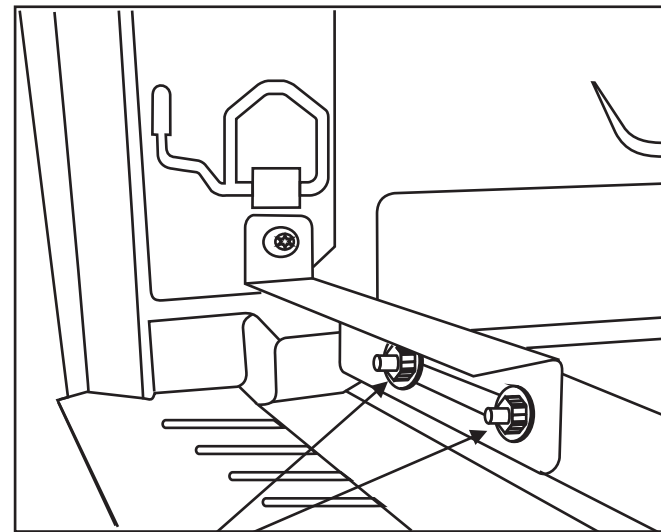

**STEP 5** Using supplied Bracket Bolts, attach the (2) 3/8" nuts and bolts to Bedslide and Midgate brackets. 2 right side, 2 left side.

**5**

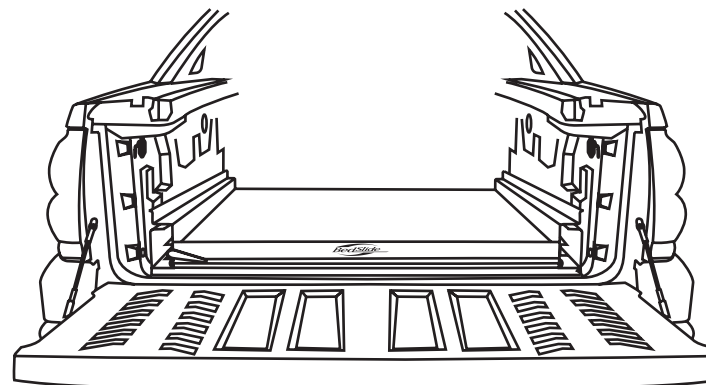

**STEP 7** Square/align the Bedslide with vehicle and tighten all bolts to vehicle and the Bedslide Floor frame. Latch the Sliding Load Floor in the closed position.

**INSTALLATION IS COMPLETE !**

The Bedslide is designed to carry no more than 1000 pounds of evenly distributed weight in the extended position.